

**MARCH 18-19, 2002**

**THE 5<sup>th</sup> ANNUAL  
COMBINED  
GEORGIA  
ASSE/AIHA  
PROFESSIONAL  
DEVELOPMENT  
CONFERENCE**

**On The Riverwalk  
Augusta, Georgia**

**Hosted By**  
Augusta Chapter ASSE  
Atlanta Chapter ASSE  
Savannah Chapter ASSE  
Georgia Local Section AIHA



**SAFETY MANAGEMENT**

**INDUSTRIAL HYGIENE**

**ERGONOMICS**

**RISK MANAGEMENT**

**CONSTRUCTION**

**OSHA/MSHA UPDATES**

**CSP-COC POINTS, CIH-CM POINTS, AND CEU's**

**BE THERE !!!**

Augusta ASSE  
C/O ATC Associates  
4 George C. Wilson Ct. #B  
Augusta, GA 30909

## Monday - March 18, 2002

**Vendor Area Breakfast Buffet** 8:00AM  
**Combined Session** 9:00AM

Keynote Address - U.S. Rep – Charlie Norwood (invited)  
Chairman of the Subcommittee on Workforce Protections

**Concurrent Sessions** 10:00AM

**Successful Ergonomics Prgs –**  
Don Robinson, CSP, CPE, Gold Kist, Inc.  
**Lockout/Tagout Programs -**  
Gayle Fratto, GA Tech Research Institute  
**1-800 Hows My Driving Works!!! -**  
Jodda Perry

**Concurrent Sessions** 11:00AM

**New Issues of Behavior Based Safety**  
Steven Luttrull, Behavior Science Technology, Inc  
**Practical Lessons in Management Systems Integration**  
Les Smith DNV  
**Traffic Safety in the Workplace**  
Ben Harper, GA Ofc of Highway Safety

**Vendor Area Lunch Buffet** 12:00Noon

**Concurrent Sessions** 1:30PM

**Ventilation System Design and Evaluation.**  
Jonathon Hale Jackson-Hale Env Technologies  
**Pain Management in Rehabilitation**  
Dr. Brandon Walton Rehabilitation Hospital  
**Behavior Based Safety at UPS**  
Scott Barker United Parcel Service

**Concurrent Sessions** 2:30PM

**Safety/Health of Airport Expansion**  
Paul Kennedy Hartsfield Intl Airport (Atlanta)  
**Key OSHA Training Reqs**  
David Smith, Constangy, Brooks, and Smith  
**Second Injury Trust Fund**  
Anne Burnett, Georgia Second Injury Trust Fund

**Concurrent Sessions** 3:30PM

**OSHA Recordkeeping**  
Kirk E. Mahan Georgia Pacific Corporation  
**Beryllium Wipe Sampling**  
Speaker TBD, Westinghouse Savannah River Co.  
**Fall Protection for General Industry**  
Steve Hays GA Pacific

**Concurrent Sessions** 4:30PM

**Accident Investigation**  
Vic Garrison Liberty Mutual  
**Occ Health Case Histories**  
Dr. Miller - Univ Hosp Occ Health  
**Developing a Safety Culture – A Leadership Approach**  
Jim Roughton

**Vendor Area Cocktail Reception** 5:30PM

## Tuesday - March 19, 2002

**Vendor Area Breakfast Buffet** 8:00AM  
**Combined Session** 9:00AM

Keynote Address - Commissioner Michael Thurmond (invited)  
Georgia Commissioner of Labor

**Concurrent Sessions** 10:00AM

**Life Safety Codes -**  
Fred Freiburger CIH, CSP, PE  
**Respiratory Protection Update**  
Rick Beaty, Bacou  
**Real Workplace Violence**  
Mike Belcher Cingular

**Concurrent Sessions** 11:00AM

**Special Considerations of Confined Space Entry**  
Mary Reed  
**Adding “Performance” to Your Safety Process**  
Kemp Nussbaum, Palmer & Cay  
**Occupational Health Exposures in Electric Power Generation Facilities**  
UGA Grad Student Contact Phil Williams

**Vendor Area Lunch Buffet** 12:00Noon

**Concurrent Sessions** 1:30PM

**Burn Injuries in Georgia**  
Jeanne Gooding Joseph Still Burn Center  
**Construction Safety**  
Denny Meece Allen & Graham Construction Co  
**IH Topic**  
Rich DeLuca

**Concurrent Sessions** 2:30PM

**Electrical Safety**  
Tony Branan Mr. Electrical Safety  
**Construction Industrial Hygiene**  
Matthew Parker ATC Associates  
**Inside the Washington Beltway**  
Aaron Trippler - AIHA

**Concurrent Sessions** 4:00PM

**Overview of Industrial Hygiene**  
David Trotter Macon Occ. Medicine  
**Risk vs Benefit of Energy Sources**  
Steven Jahn Westinghouse Savannah River Co.  
**Fiber Release during removal of Asbestos containing gaskets**  
Richard Hatfield

**Adjourn** 5:00PM



## GOLF TOURNAMENT

Gather with ASSE members and guests in a casual atmosphere to network, develop business relationships, and have fun!

**Type** 4 person Captain's Choice Tournament  
(Captain decides best shot)

**Time** Sunday afternoon – March 17, 2002  
1:00 p.m.

**Location** Jones Creek Golf Course  
Evans, GA

**Fee** \$70.00 per person.  
covers green fees, golf cart, dinner, and prizes

**Due Date** **Friday - March 1, 2002**

**Transport** Course is 10 miles from the Radisson Hotel.  
Rules/Instructions presented at 12:30 p.m. by Tournament Committee. Mulligans may be purchased at a maximum of 2 per person - \$5.00 each. Best Team Score and special awards: 1st Place, 2<sup>nd</sup> Place, 3<sup>rd</sup> Place, Last Place Longest Drive and Closest to the Pin. In the event of a tie, scorecards will be used to determine winner from hole #18 back. Handicaps will be used. Awards will be presented at Dinner immediately following tournament

## CONFERENCE ACCOMODATIONS

The Radisson Riverfront Hotel Augusta extends a gracious welcome to those who visit. It provides direct access to a variety of museums, art galleries, antique shops and eateries. The 234 luxurious guest rooms are spacious and include many amenities in each room. Beautiful views of the Savannah River, Riverwalk and downtown Augusta abound.

**The Augusta Chapter has negotiated a reduced room rate at the Radisson King, Queen and Double rooms are available at \$111.00.**

**Reservations must be made on an individual basis  
NO LATER THAN 3/1/2002.**

Call 800-333-3333 for Radisson reservations and 800-456-4000 for Country Suites Reservations. Be sure to identify your affiliation with the ASSE. Room deposits must be made by advance payment or guaranteed on your personal or corporate credit card. Guests are responsible for late arrival guarantees/cancellations

## TOURS AND DOOR PRIZE

### Technical Tour – Club Car



Based in Augusta, Club Car manufactures 40 base models of golf carts for golf course, grounds maintenance, industrial, & academic markets. See state of the art manufacturing and meet the EHS staff

**Monday – March 18, 2002**

**3:00 PM-5:00 PM**

**\$15.00**

### Cultural Tour - Augusta Golf and Gardens

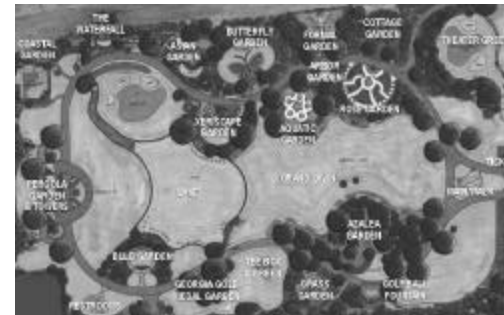

Encompassing 17ac. along the Savannah River. The site includes eight acres of gorgeous display gardens and a 55,000 square-foot main building featuring the golf hall of fame, theatre exhibits, and more!

**Monday – March 18, 2002**

**3:00 PM-5:00 PM**

**\$5.00**

## DOOR PRIZE

In addition to the door prizes the vendors will be awarding, a 29" Television has been selected as the GRAND PRIZE. The GRAND PRIZE will be awarded from entry certificates included in your registration packet. EACH of the vendors present must sign your certificate before it will accepted for the drawing. You must be present to win.

# PROFESSIONAL DEVELOPMENT

The theme of this year's conference is:  
**Safety and Health**  
**is more than Good Luck**



With that thought in mind we've invited professionals from every discipline of the safety and health profession to share their information on the latest trends in safety and health management

***Enhance your professional performance***

You may want to go to the AIHA national conference in San Diego or ASSE national conferences in Nashville, but the cost and time you must invest are significant and may be hard to justify. Join us and realize the cost effectiveness of staying and learning close to home.

***Improve your value to your company or customers***

Our conference is affordable, practical, comprehensive, and professional. We have scheduled three rooms for two days with lectures running continuously in both. Our vendor exposition will match any local or regional show you've seen.

***Enjoy yourself in Georgia's second city***

Your full conference registration includes breakfast **AND** lunch on **BOTH** days as well as a cocktail reception on Monday.

***BE THERE !!!***

# REGISTRATION FORM

Name: \_\_\_\_\_

Title: \_\_\_\_\_

Certifications: \_\_\_\_\_

Company: \_\_\_\_\_

Address: \_\_\_\_\_

City: \_\_\_\_\_ State: \_\_\_\_\_ Zip: \_\_\_\_\_

Work Phone: \_\_\_\_\_ Fax: \_\_\_\_\_

Email address: \_\_\_\_\_

ASSE/AIHA Chapter Affiliation \_\_\_\_\_

Event	Fee	#	Total
Full Conference Registration	\$115		
One Day Registration (does not include reception)	\$65		
Guest Registration (Meal Tickets Only for 2 Days)	\$80		
(check one) <input type="checkbox"/> Technical Tour or <input type="checkbox"/> Cultural Tour	\$15		
Expo Only	\$25		
Golf Tournament Handicap _____	\$70		
Transportation (to/from Atlanta or Savannah)	\$25		
10Hr OSHA Construction Safety Course (Sunday)	\$65		
	<b>Subtotal</b>		
AIHA/ASSE # _____ \$15 Member Discount	<b>Less</b>		
	<b>Total</b>		

Method of Payment	
<input type="checkbox"/> Check (Check Payable to Augusta ASSE must accompany registration)	
<input type="checkbox"/> Charge: <input type="checkbox"/> AmEx <input type="checkbox"/> Visa <input type="checkbox"/> Mastercard	
Name As It Appears On Card _____	
Card # _____ Exp. Date _____	
Signature _____	
<b>Return to: M. Parker, 4 George C Wilson Ct. #B, Augusta GA 30909</b> <b>Credit Card Registrations ONLY can be faxed to 706-210-4471</b>	