



Georgia Local Section
American Industrial Hygiene Association (AIHA)

Spring 2008 Meeting

DATE: March 25, 2008 (Tuesday)

TIME: 9:00 AM - 12:30 PM (check-in and registration at 8:30 am)

LOCATION: Northpark 500 Town Center – 3rd Floor – Peachtree-Dunwoody Room
1200 Abernathy Road, Atlanta, GA 30328

COST:

Pre-registration - members	\$15.00
Pre-registration - non-members	\$20.00
Onsite Registration - members	\$20.00
Onsite Registration - non-members	\$25.00

TO RSVP: Kristen Bulter, MPH
Email: kristen.butler@gtri.gatech.edu :
Phone: 404-407-6643

Please Pre-Register by March 18, 2008

Make checks payable to GA Local Section – AIHA.
You can also pay your Annual Dues (\$20) at the meeting.

You may register by email, with the expectation of payment at the meeting (whether or not you attend)

Agenda		
<i>Time</i>	<i>Topic</i>	<i>Speaker</i>
8:30 - 8:50	Registration	
8:50 - 9:00	Welcome and Announcements	Barb Epstien, MPH, CIH, President Elect-GLS, Epstien Environmental Resources
9:00 - 9:45	<u>Public Health Issues Related to Naturally Occurring Asbestos (NOA) in Communities</u>	<u>Jill J. Dyken PhD</u>, Environmental Health Scientist, ATSDR
9:45 - 10:30	The Use of GIS for Assessing NOA Sites	Robert C. Neurath, MS, GIS Analyst, ATSDR
10:30 - 10:45	Break	
10:45 - 11:30	ATSDR's Exposure Investigation of Illinois Beach State Park	James T. Durant MSPH, CIH, Environmental Health Scientist, ATSDR
11:30 - 12:15	Characterization of World Trade Center Dust	Rich Brown, MS Executive Director, MVA Scientific Consultants
12:15 - 12:30	Closing Remarks	GLS Board

For further information about the meeting, please call.
ABIH Certification Maintenance (CM) points will be applied for.



Georgia Local Section American Industrial Hygiene Association (AIHA)

Directions to Northpark Town Center

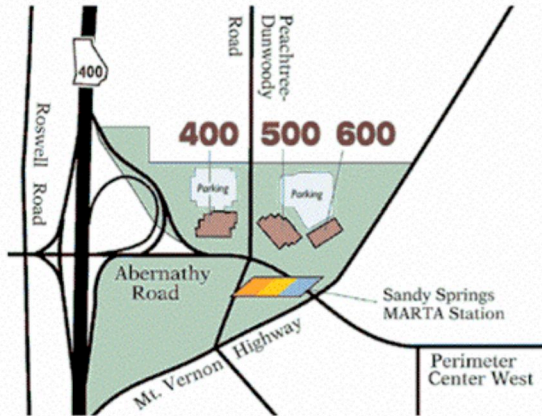

Northpark 500 ~ Third Floor

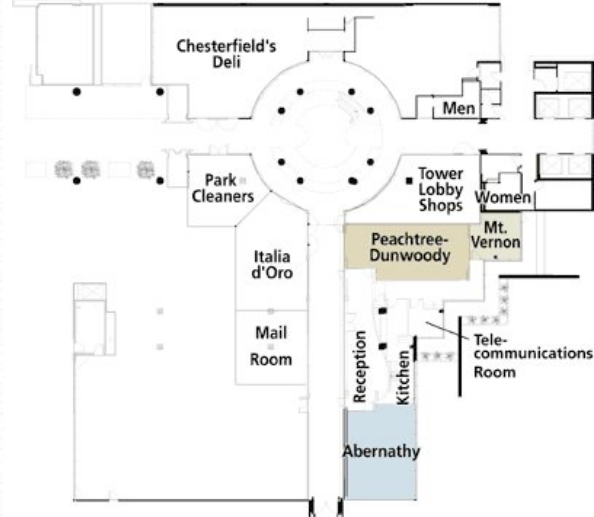

1200 Abernathy Road, Atlanta, GA 30328 From Interstate 75

Interstate 75 to 285 East. Travel approximately 7 miles to Exit 27 Georgia 400 North to Exit 5A Abernathy Road. Turn left at 2nd light onto Peachtree Dunwoody Road. Northpark 400 is on the left and Northpark 500 and 600 are on the right.

From 75/85 Downtown

85 North to Georgia 400 Toll Road. Exit 5A Abernathy Road. Turn left at 2nd light onto Peachtree Dunwoody Road. Northpark 400 is on the left and Northpark 500 and 600 are on the right.

From Interstate 85

Interstate 85 to 285 West. Travel approximately 7 miles to Exit 27 Georgia 400 North. Exit 5A Abernathy Road. Turn left at 2nd light onto Peachtree Dunwoody Road. Northpark 400 is on the left and Northpark 500 and 600 are on the right.

From 285

285 East or West to Exit 27 Georgia 400 North. Exit 5A Abernathy Road. Turn left at 2nd light onto Peachtree Dunwoody Road. Northpark 400 is on the left and Northpark 500 and 600 are on the right.

From Interstate 20 East of 285

Take Interstate 20 West to 285 North to Exit 27 Georgia 400 North. Exit 5A Abernathy Road. Turn left at 2nd light onto Peachtree Dunwoody Road. Northpark 400 is on the left and Northpark 500 and 600 are on the right.

From Interstate 20 West of 285

Take Interstate 20 East to 285 North to Exit 27 Georgia 400 North. Exit 5A Abernathy Road. Turn left at 2nd light onto Peachtree Dunwoody Road. Northpark 400 is on the left and Northpark 500 and 600 are on the right.

Parking

Northpark offers ample free parking for tenants and visitors. Northpark 500 and 600 share a garage behind those towers (there is also a garage behind Northpark 400, across the street).

Visitors who have plans to stay longer than one hour are asked to park in unmarked spaces.